

Row 4: House/Tree/Star Block - February Drawing

Please read all instructions before beginning. This block will be 12 1/2" x 12 1/2" unfinished (12" x 12" finished).

This is the fourth block in a series. Make blocks in the colors indicated for the block of the month drawing at the February meeting, and make three blocks in the colors of your choice for your row quilt.

Part 1: House Block (8 1/2" x 12 1/2")

- ✓ Background – cream – reads as a solid
- ✓ House – medium to dark – plaid/striped/small print
- ✓ Roof – fabric that goes well with house fabric
- ✓ Chimney – brick red
- ✓ Door – dark that contrasts with house fabric
- ✓ Window – light that contrasts with house fabric

For the block of the month the general feel should be homespun/folk art. You will want to consider the feeling you want your quilt to have when picking the fabrics for your row quilt. This is a great quilt to making using up your scraps from previous quilts.

Cutting for one block:

A – background: one 4 1/2" square	K – house: one 1 1/2" x 6 1/2" rectangle
B – background: one 2 1/2" x 4 1/2" rectangle	I – house: two 1 1/2" x 6 1/2" rectangles
D – background: one 1 1/2" x 4 1/2" rectangle	G – house: one 2 1/2" x 3 1/2" rectangle
C – chimney: one 1 1/2" x 4 1/2" rectangle	J – door: one 2 1/2" x 6 1/2" rectangle
E – roof: one 4 1/2" x 8 1/2" rectangle	H – window: one 2 1/2" x 3 1/2" rectangle
F – house: one 2 1/2" x 8 1/2" rectangle	

Sew B to one side of C and D to the other side

Sew Background (A) diagonally to corner of E roof.
Sew B/D/C unit to other corner of E roof (watch the direction of the chimney).

Press to the corners and cut away the extra layers

Sew H to G.

Assemble as shown in diagram

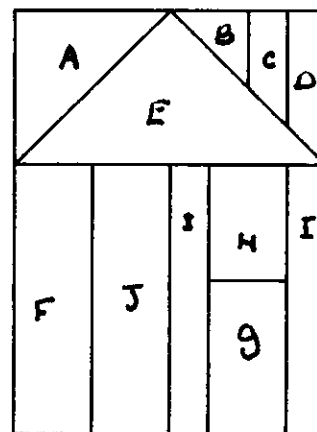

Part 2: Star Block (4 1/2" x 4 1/2")

- ✓ Background – cream – reads as a solid
- ✓ Star Center – yellow or gold, plaid stripe, small print
- ✓ Star Points – yellow or gold, compliments center

Cutting for one block:

A – background: four 1 1/2" squares	C – star center: one 2 1/2" square
B – background: four 1 1/2" x 2 1/2" rectangles	D – star points: eight 1 1/2" squares

This is basically the same sawtooth star we did last year, only smaller.

Sew a D diagonally to one corner of each B.
Press to the corner and cut away the extra layer.
Repeat on the other corner of each B.
Assemble as shown in diagram .

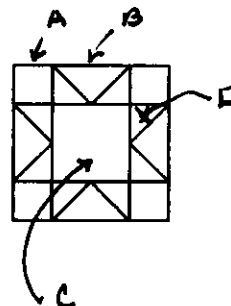

Row 4: House/Tree/Star Block - February Drawing

Part 3: Tree Block (4 1/2" x 8 1/2")

- ✓ Background – cream – reads as a solid
- ✓ Tree – medium to dark green – plaid/striped/small print
- ✓ Tree trunk – brown fabric that goes well with tree fabric

Cutting for one block:

A – background: six 2 1/2" squares	B – tree: three 2 1/2" x 4 1/2" rectangles
C – background: two 2 1/2" x 2" rectangles	D – trunk: one 2 1/2" x 1 1/2" rectangle

Sew an A diagonally to one corner of each B.
 Press to the corners and cut away the extra layer.
 Repeat on the other corner of each B.

Sew a C to each side of each D.

Assemble as shown in diagram.

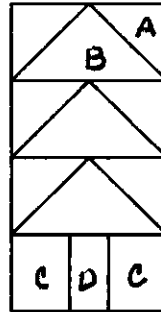

Sew the tree to the star.
 Sew the tree/star to house.

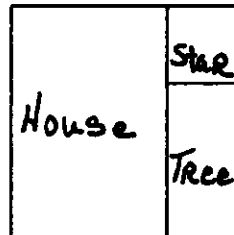

For your row quilt, make three blocks and use spacer sashings so that the actual length of your row matches Row 1 (this may vary slightly as everyone does not sew the same exact 1/4" seam). You might want to be creative and make an extra house, or several extra tree/stars to use as spacers. Put this row in a safe place until you are ready to assemble your quilt.

Assemble as follows:

